

# CONTROL PANEL 1410-33-1517 - 3

## MOUNTING

The control panel should be mounted in a dry area adjacent to the sauna cabin. The thermostat sensor must be wall mounted within the sauna. Please follow the measurements in the heater instructions to avoid the possibility of scorching the wood.

## TIMER

The timer control (2) which is the main on /off switch has two scales which are set with the rocker-switch/pilot light (3). To switch on, turn knob clockwise: Scale A provides first a 1 - 4hr working band, then a 1 - 8 hr preset band which delays the switch on time. Scale B provides up to 12 hr working time

When the sauna is finished, the timer knob may be turned back to the off position or left to switch off automatically at the end of the set working time.

## REGULATION OF TEMPERATURE

The thermostat control (1) regulates temperature. Turn clockwise to achieve stepless increase of temperature level in the sauna. Resetting the thermostat each time the sauna is used is unnecessary. When the position which maintains the desired temperature has been found, the knob may be permanently left at this setting.

## LIGHT SWITCH

A rocker-switch (5) is provided for connection to the light fitting in the sauna.

## SENSOR UNIT

The recommended mounting dimensions for the sensor are shown in the heater instructions. A 3 metre length of heat-resistant cable (170 °C) 4 x 0,5mm - is provided. This may be extended with normal low voltage cable Outside the sauna cabin. Connection details for the sensor are shown in fig. 4.

## LIMIT CONTROL

If the temperature in the sauna should rise too high (for example due to a thermostat fault) the limit switch in the sensor will turn off the power. When the fault has been rectified the switch may be reset.

Fig 3

## CONTROL PANEL

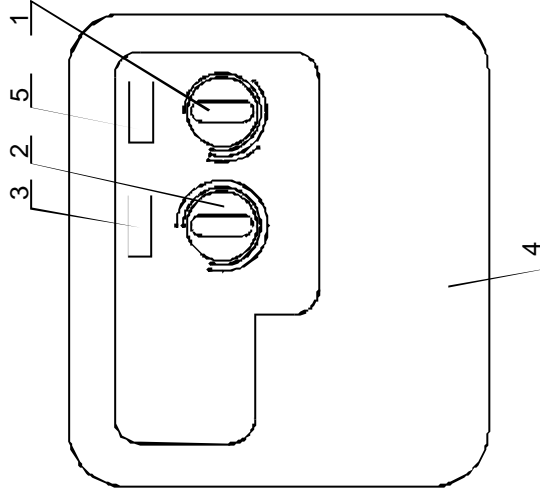

1. Thermostat
2. Timer
3. Pilot lamp
4. Space for connection
5. Sauna light

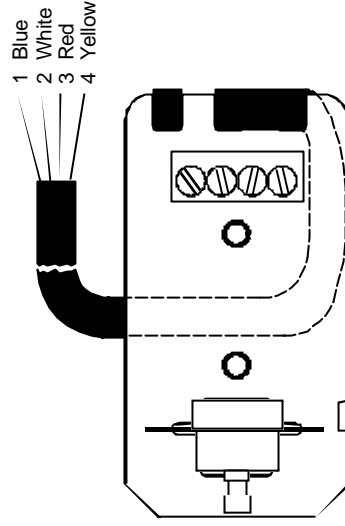

Front side

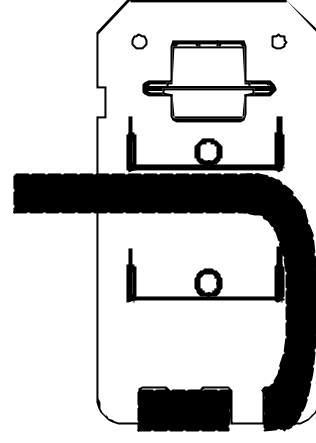

Back side

- Sensor installation

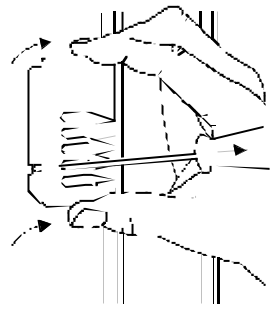
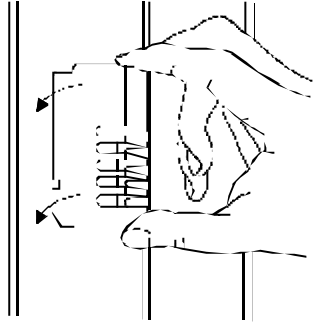
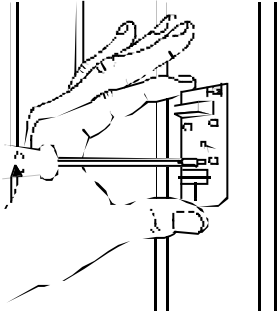
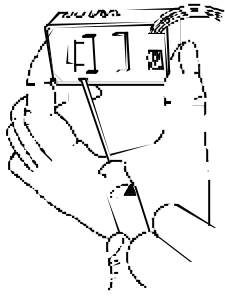

- Removing of the cover

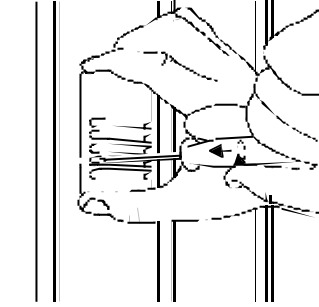

INSTALLATION

The control panel should be mounted in a dry area outside the sauna room  
 The sensor must be installed as shown in the illustration below.  
 Digression from these instructions may cause overheating and risk for fire

